



**42/553-555 Melton Highway Sydenham VIC**

**3**  **2**  **2** 

**PRIME LOCATION - WALK TO WATERGARDENS SHOPS & STATION**

**Price** : \$ 420,000

**View** : <https://www.ypa.com.au/7395060>

Excellent Opportunity for the 1st Homeowner or Investor

This Spacious Town House features:-

- 3 Good Bedrooms, master with ensuite & all with Bir's
- Spacious Open Plan Living area & well equipped kitchen with dining
- Main bathroom upstairs, 3 toilets & sep laundry
- Double Garage with internal access, work space and private garden area
- Private rear yard adds to living space, perfect for entertaining family and friends
- Security gate entrance with intercom, well maintained swimming pool & gym for your enjoyment
- Ideal home or investment returning \$1603.00/mth approx



**Joe Albioli**  
**0438 133 123**

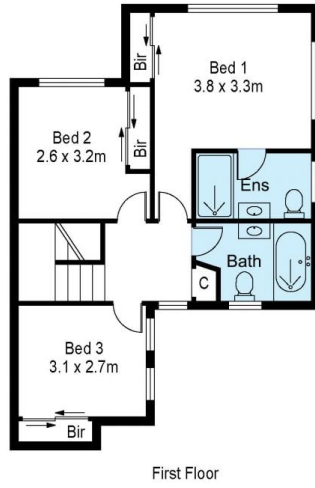
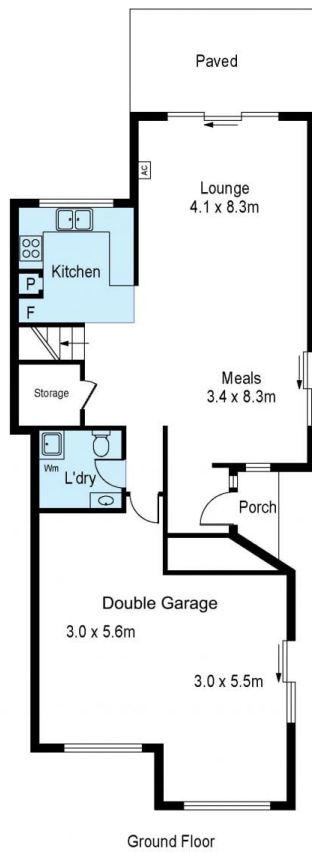

Scale in metres. Indicative only. Dimensions are approximate. All information contained herein is gathered from sources we believe to be reliable. However we cannot guarantee its accuracy and interested persons should rely on their own enquiries

42/553-555 Melton Highway, Sydenham

