



42 Centre Drive Rye VIC

3  2  4 

Set on an idyllic 916*m2 allotment in one of the most sought after streets on the southern peninsula, this immaculate family home located just 700*m from the magical Tyrone Foreshore, represents an exciting blue-chip opportunity to secure your financial future with an immediate return.

Behind the secure gated entry and down the crushed rock drive, a charming, quality built brick home awaits. Nestled towards the rear of the block for maximum privacy and a sense of grandeur, the home is also cleverly positioned to maximise the highly desirable north easterly aspect.

Cathedral ceilings are enjoyed throughout as well as a cosy wood burning fireplace in the main living space, split system air-conditioning in dining, modern kitchen with gas cooktop, interior brick feature walls, timber look flooring, large picture windows and a sun drenched terrace located straight off the kitchen. Three light filled bedrooms offer

Price : \$ 1,360,000

Land Size : 916 sqm

View : <https://www.ypa.com.au/7393559>



Tony Talarico
0420 778 401



Katrina Talarico
0420 778 404

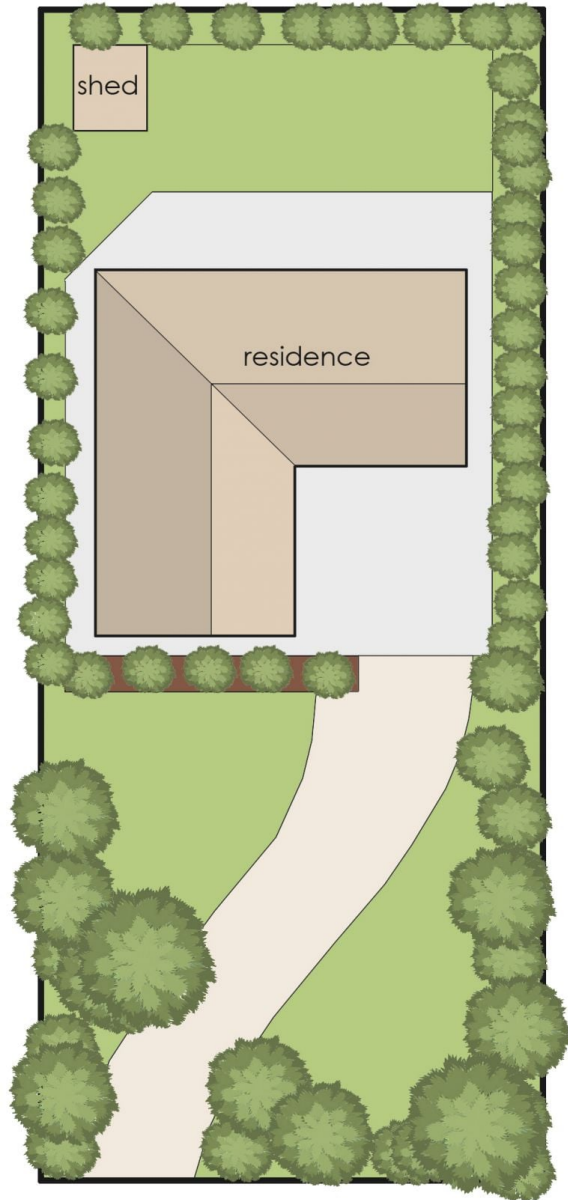
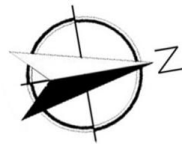

42 Centre Drive, Rye

This floorplan is for illustration purposes only and no warranty is given to its accuracy. Purchasers are advised to carry out their own investigations.