



6 Stratford Road Rye VIC

3 1 3

Impeccably renovated and displaying the pinnacle in modern coastal living, this spectacular Peninsula family home will delight and surprise the most discerning buyer.

Set on a private, elevated allotment of over 880*m2 and surrounded by the raw natural beauty of this spectacular back beach location, the beautifully landscaped grounds, established gardens and intimate 'year round' entertaining space (including outdoor TV, ceiling fan and pizza oven) offers a picture of authentic seaside charm and delivers a true indoor/outdoor living experience.

Beautiful coastal flooring, solid timber decking, and an expansive backyard with the potential to add in a pool (stca) are just some of the outstanding property inclusions enjoyed at this simply stunning residence.

Price : \$ 1,395,000

Land Size : 881 sqm

View : <https://www.ypa.com.au/7393502>



Tony Talarico
0420 778 401



Katrina Talarico
0420 778 404

Property Features

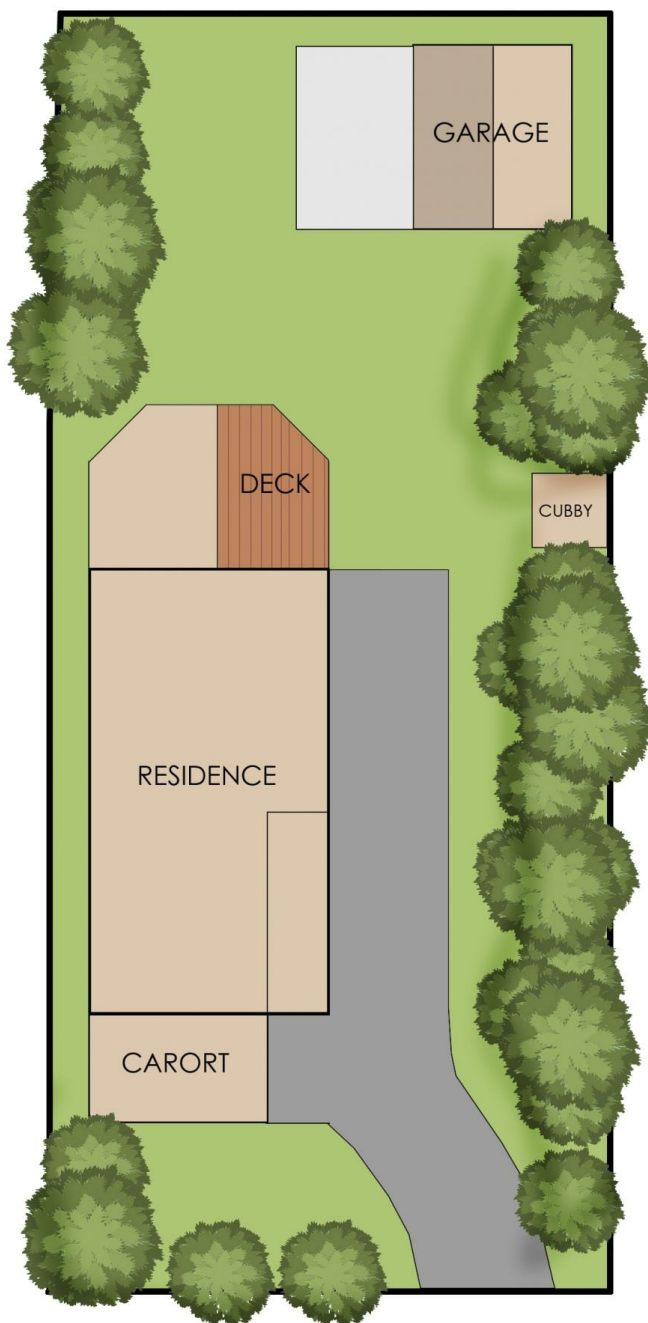
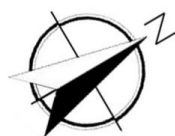
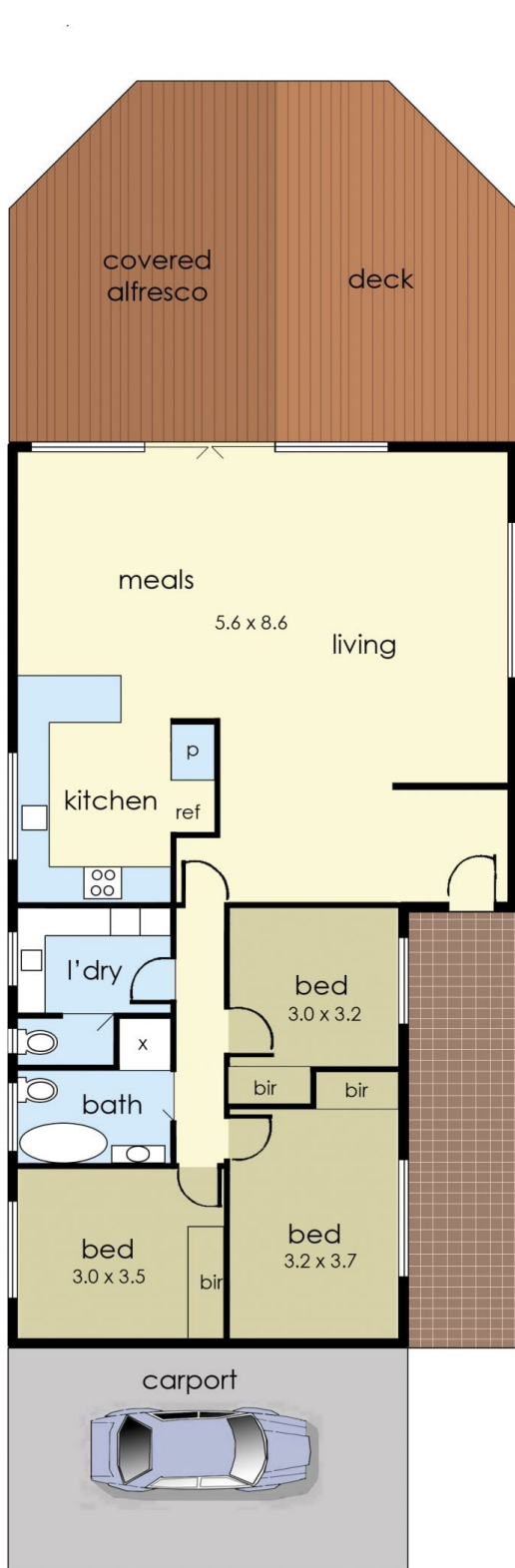

6 Stratford Road, Rye

This floorplan is for illustration purposes only and no warranty is given to its accuracy. Purchasers are advised to carry out their own investigations.