



95 Glenvue Road Rye VIC

4 3 2

Positioned just moments from some of the most captivating and pristine coastline in Australia, an incredible opportunity exists in the coveted Rye Ocean Beach locale, to secure your future and turn your dreams into reality. Located just a short walk to the spectacular 16 Beach & popular General Store as well as just minutes from the world class Dunes Golf Course, Peninsula Hot Springs Day Spa, Moonah Links and, summer hot spot - St Andrews Brewery - there is a reason why Rye is one of the most sought after postcodes in Australia!

A seaside retreat surrounded by nature and a peaceful calm stillness, the solid brick, four bedroom family home has room for everyone! Situated on a huge 1039*m2 allotment, there is also room for multiple cars, your boat or caravan or even the option to include a pool or perhaps a major renovation to create your dream coastal home (both STCA).

Price : \$ 1,120,000
Land Size : 1039 sqm
View : <https://www.ypa.com.au/7393450>



Tony Talarico
0420 778 401



Katrina Talarico
0420 778 404



INTERNAL LIVING AREA
APPROX. 143.9 SQUARE METERS

PORCH AND ENTERTAINING
APPROX. 19.5 SQUARE METERS

GARAGE AND STORAGE
APPROX. 81.1 SQUARE METERS

TOTAL AREA
APPROX. 244.5 SQUARE METERS

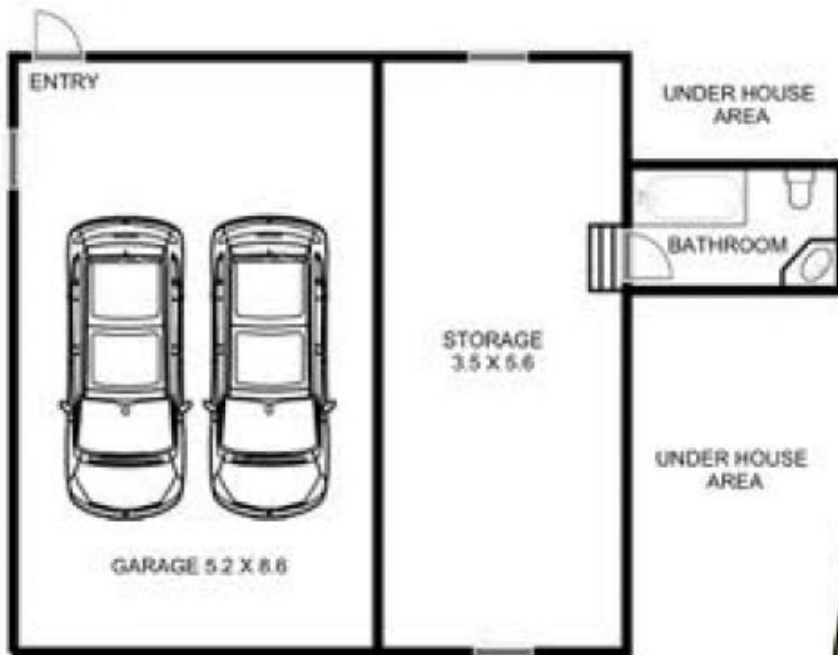

95 GLENVUE ROAD RYE

This is an artistic representation. All measurements, dimensions and illustrated areas are approximate. It is the responsibility of all interested parties to verify all data depicted and omitted.