

**24 Pearse Road BLAIRGOWRIE VIC**

4 3 2

PROPERTY AVAILABLE TO INSPECT BY PRIVATE APPOINTMENT. PLEASE CONTACT JADE ON 0437 410 791 OR KATRINA ON 0420 778 404 TO ARRANGE.

**Land Size** : 1687 sqm  
**View** : <https://www.ypa.com.au/7393209>

Check out our full video tour in 4K, showing everything this property has to offer. PLEASE NOTE: THIS IS NOT JUST A SLIDESHOW!!!

A rare and beautiful example of true Southern Peninsula living, this dreamy back beach coastal abode is so peaceful, you may never want to leave. Positioned on just under 1700m<sup>2</sup>\* of almost perfectly flat land and surrounded by native gardens and the sounds of the crashing waves of Peares beach, this double storey cedar wood home is sure to be love at first sight!



**Jade Springer**  
**0437 410 791**

This gorgeous property is comprised of four bright

Rear Access  
to Royadie Road

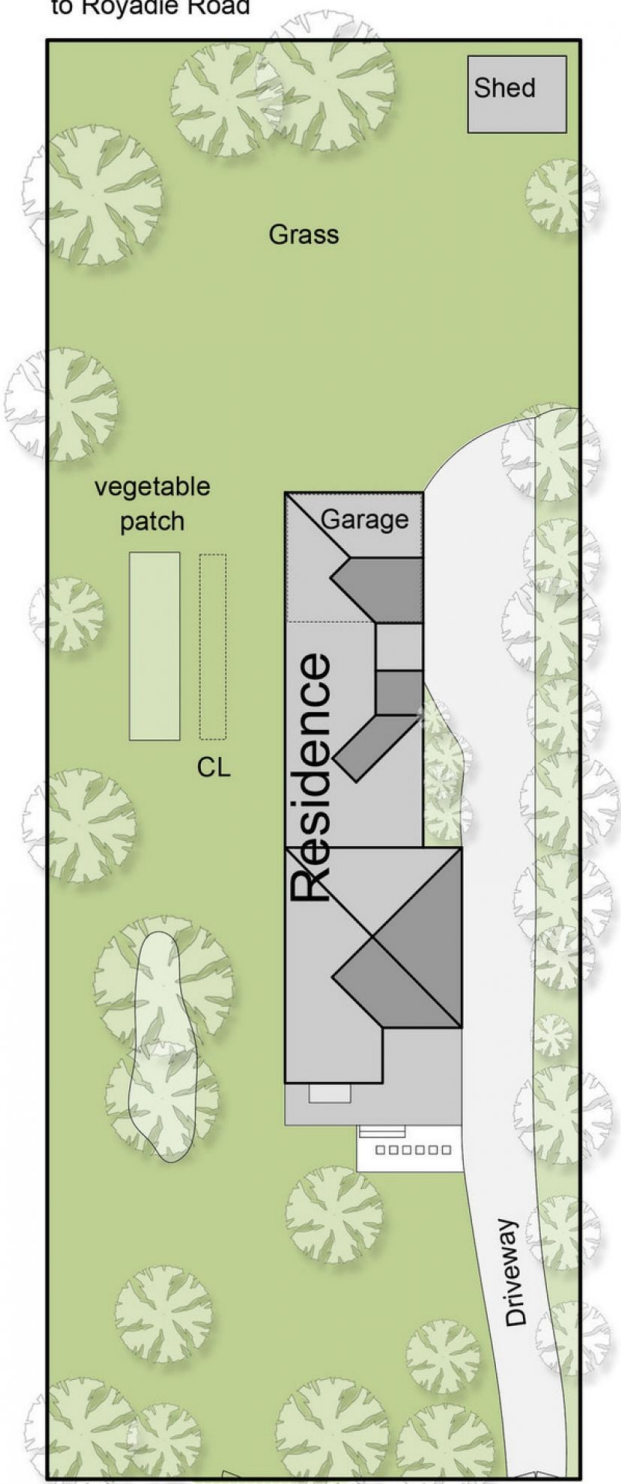

**Site Plan**

Land Size  
1686 sqm

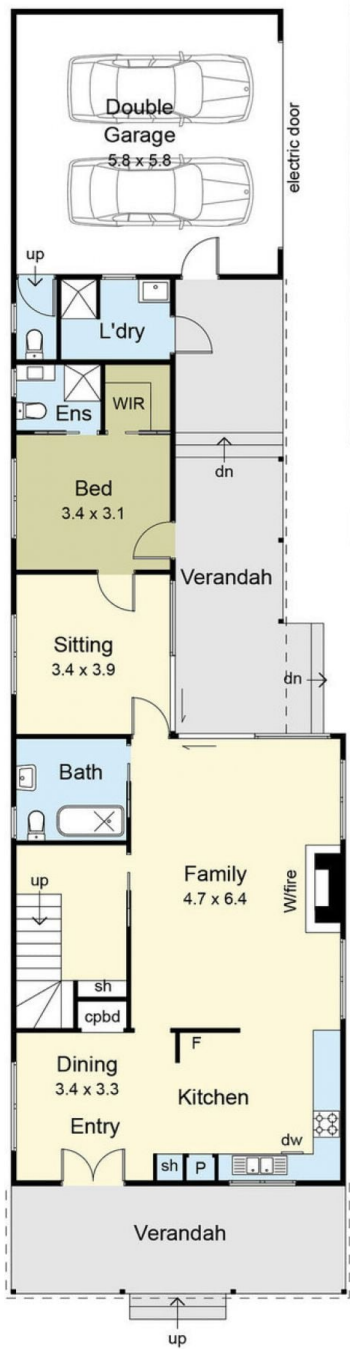

**Ground Floor**

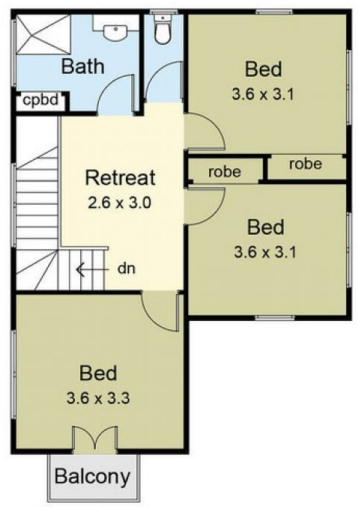

**First Floor**

**24 Pearse Road, Blairgowrie**

This floor plan has been prepared with all due care to the accuracy of the above information. Purchasers are advised to make their own investigations.

