



59 Grandview Avenue RYE VIC

3  2  1 

Sitting high up on this rising allotment, this property affords tranquil treetop vistas that stretch all the way to Arthurs Seat.

Land Size : 1117 sqm
View : <https://www.ypa.com.au/7393076>

Featuring:

Perched on a generous allotment of over 1100 sqm*

Solidly built with a broad viewing balcony to take in the expansive view

Two-storey construction with the bedrooms, living areas and bathrooms on each level allowing for flexible family living

Perfect as is, yet with scope to realise further potential

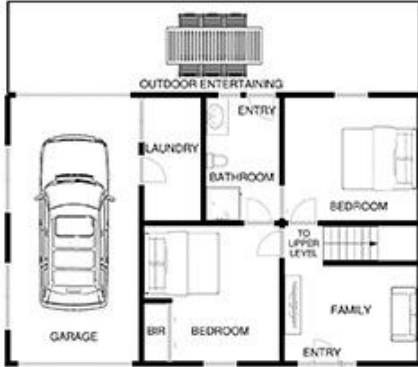

59 GRANDVIEW AVE RYE

This image is an artistic representation. It is the responsibility of all interested parties to verify all data depicted and omitted.