



125 Rainier Avenue DROMANA VIC

3 1 2

This solid brick-veneer home represents value in an increasingly sought-after neighbourhood. With generous proportions and light and airy interiors, the level allotment and huge storage shed is yet another bonus in this value-packed package.

Land Size : 710 sqm

View : <https://www.ypa.com.au/7392831>

Featuring:

Three bedrooms, including a walk-in robe and two-way en suite to the master bedroom

Raked ceilings and easy-care flooring enhance the sense of space

Nestled on a fantastic parcel of land with level lawn areas- ideal for entertaining and the children/ pets

Central bathroom with both shower and bath, as well as a separate laundry and toilet

Huge shed at the rear of the property- perfect for the



Ben Nutbean
0413 125 996

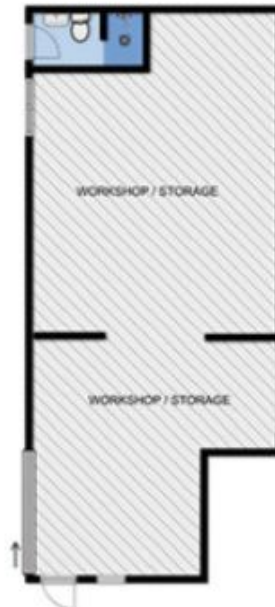

WORKSHOP



RESIDENCE

125 RAINIER AVE DROMANA

This image is an artistic representation. It is the responsibility of all interested parties to verify all data depicted and omitted.