



23 Phillip Drive Sunbury VIC

4 2 2

Located in the sought-after Killara Estate, presenting a four-bedroom home set on an impressive allotment of 650m² approximately. If you're looking for spacious living, established gardens and love to entertain then this has the complete package. With nearby schools, shops, parklands, very easy non hassle access to the Calder Freeway and public transport all at your doorstep, this immaculately presented home inside and out will be a family favourite.

Property features include:

- Master bedroom complete with walk-in robe and ensuite
- 3 other bedrooms all with built-in robes
- Open plan kitchen and dining area
- Kitchen equipped with ample cupboard space, stainless steel appliances including a electric oven, gas cooktop with rangehood and a dishwasher
- Main central bathroom with separate toilet

Price : \$ 670,000
Land Size : 650 sqm
View : <https://www.ypa.com.au/7389139>



Daniel Scarano
0448 735 298



Hayley Mayne
0497 972 028

23 Phillip Drive, Sunbury

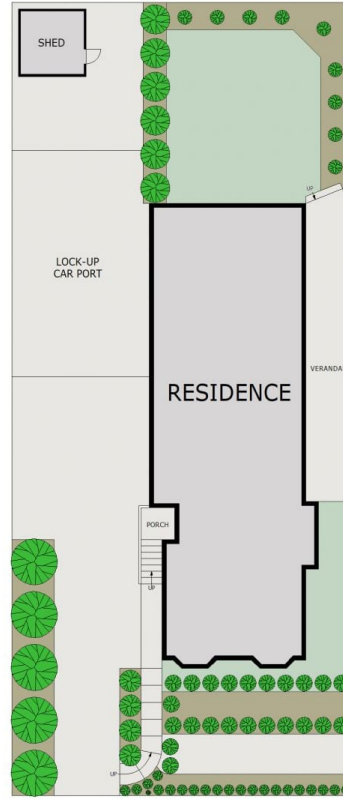

SITE PLAN

Disclaimer: All images, views and diagrams are indicative only. Dimensions, areas and landscape are indicative and subject to change without notice. Purchasers should check the plans and specifications included in the terms of the contract of sale carefully prior to signing the contract.