



24 Woodstock Close Sunbury VIC

4 2 3

Located in the sought after Strathearn Glen Estate, presenting a four-bedroom home set on an impressive allotment of 726m² approximately. If you're looking for spacious living, established gardens and love to entertain then this has the complete package. If location is a priority on your list you will get to enjoy an abundance of amenities, a few to mention include, St Anne's school, Spavin Lake, gorgeous parklands, public transport in every direction and a very short trip to Sunbury Township and Train Station.

PROPERTY FEATURES INCLUDE:

- Bedrooms all with built-in robes
- Master bedroom with walk-in robe and complete ensuite
- Kitchen equipped with ample cupboards and new stainless-steel appliances including gas cook top with

Price : \$ 765,000
Land Size : 726 sqm
View : <https://www.ypa.com.au/7389125>



Daniel Scarano
0448 735 298



Sebastien Kowlessur
0418 644 323

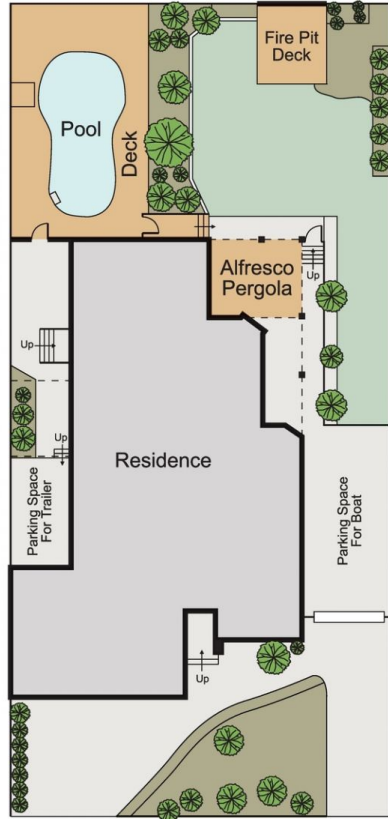
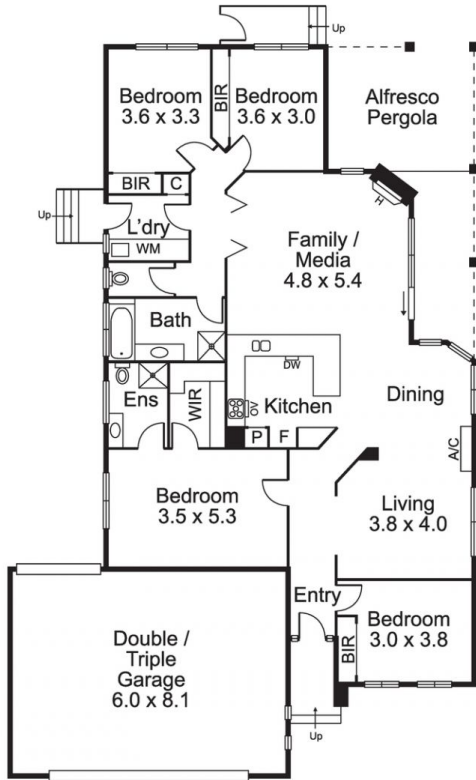

Disclaimer: All images, views and diagrams are indicative only. Dimensions, areas and landscape are indicative and subject to change without notice. Purchasers should check the plans and specifications included in the terms of the contract of sale carefully prior to signing the contract.