

48 Rosenthal Boulevard Sunbury VIC

4  2  2 

This simply stunning home is positioned in the ever-so-popular Rosenthal Estate. Ideally suitable for first home buyers, or a family looking to take advantage of an ultimate low maintenance lifestyle and endless fun for the kids. With Thomas Millett Park right across the road and only seconds away from Rosenthal shops, schools, parks, and easy access to Calder freeway.

Price : \$ 635,000

View : <https://www.ypa.com.au/7389089>

Property features include:

- ? 4 Bedrooms all with built-in robe
- ? Master bedroom with walk-in robe and ensuite
- ? Main central bathroom with separate toilet
- ? Kitchen with ample cupboards and stainless-steel appliances (Gas cooktop, oven, dishwasher and rangehood)
- ? Open plan living and dining
- ? Lounge room



Patrick Kilkenny
0401 175 248



Sebastien Kowlessur
0418 644 323

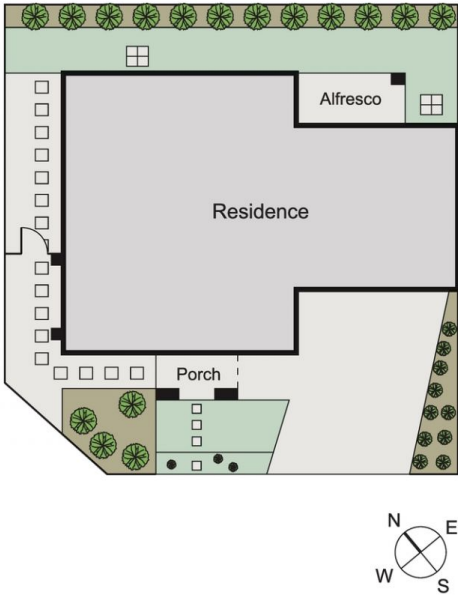
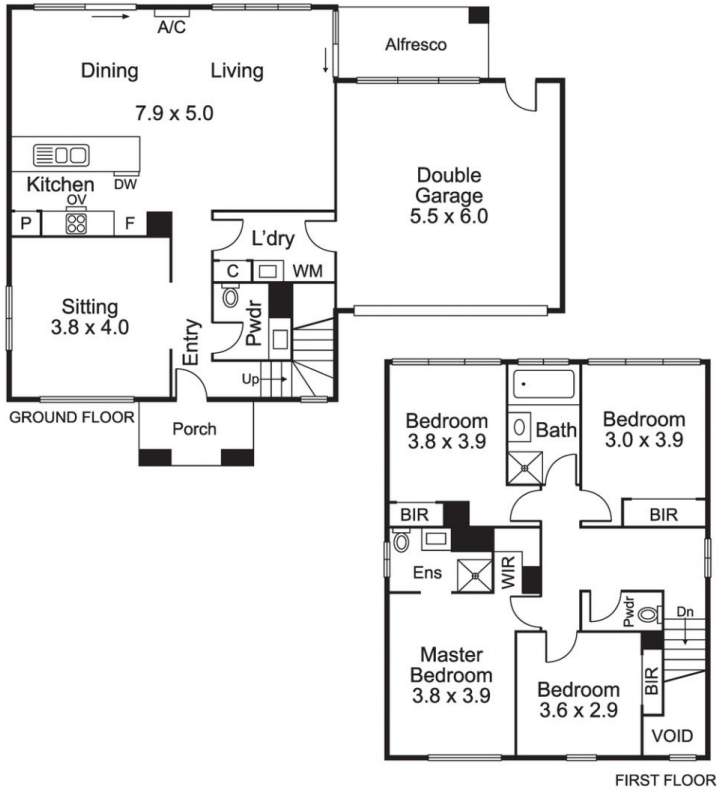

Disclaimer: All images, views and diagrams are indicative only. Dimensions, areas and landscape are indicative and subject to change without notice. Purchasers should check the plans and specifications included in the terms of the contract of sale carefully prior to signing the contract.