



## 315 Elizabeth Drive Sunbury VIC

3 1 3

Whether you're a first home buyer, savvy investor or someone seeking for a new project, this is definitely the right choice for you. We present you this gorgeous home on an impressive block size of 637m<sup>2</sup> (Approx.) On offer is three bedrooms, low-maintenance gardens, and drive-through access for those searching for extra space. With everything you could possibly think of at your fingertips such as public transport, schools, parklands, sporting facilities, and not forget to mention your only minutes away from Sunbury Township.

**Price** : \$ 580,000  
**Land Size** : 637 sqm  
**View** : <https://www.ypa.com.au/7389066>

Property features include:

- ? 3 bedrooms, all with built-in robe
- ? Master with walk-in robe
- ? Main central bathroom
- ? Kitchen with ample cupboards, gas cooktop and oven



**Patrick Kilkenny**  
0401 175 248

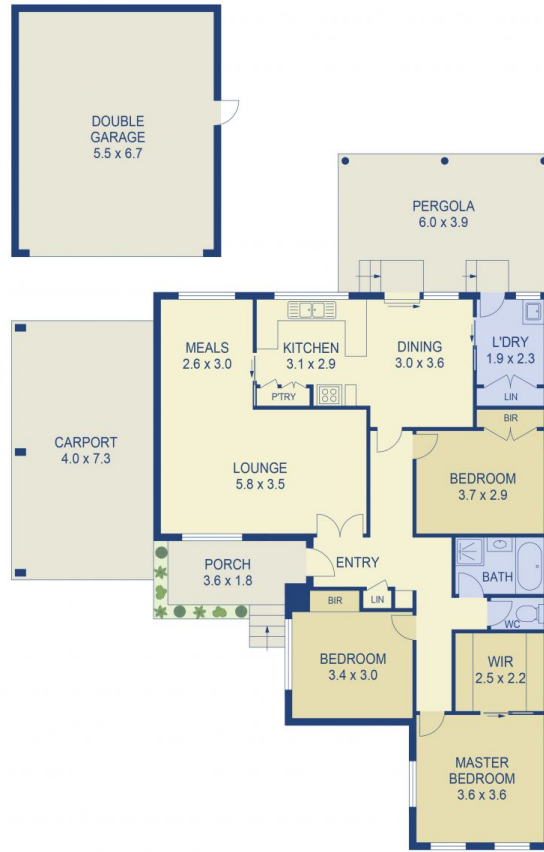

**ypa**

315 Elizabeth Drive, Sunbury

Note: Every precaution has been taken to verify the accuracy of the above detail. However, prospective purchasers are advised to make their own enquiries.