



## 36 Kingsley Drive Sunbury VIC

3 2 2

Welcome to this immaculate family residence packed with charm and personality! Situated in the Langama Park Estate and behind a very cute facade comes a home that is sure to tick so many boxes. It will perfectly accommodate the growing family as you'll be spoilt with dual living zones, great entertaining space and have the enjoyment of a playground right outside your front door! Affordable and ready to move into, properties such as these definitely DO NOT LAST LONG! Especially with the close proximity of the brand-new Rosenthal Woolworths and other handy shops within the same strip, Sunbury's township, transport, Calder Freeway and much more!

Property features include:

- ? 3 bedrooms all with built-in robes
- ? Master bedroom complete with walk-in robe and ensuite
- ? Split level with two separate living zones

**Price** : \$ 530,000  
**Land Size** : 665 sqm  
**View** : <https://www.ypa.com.au/7388866>



**Lisa Totaro**  
0410 144 215



**Hayley Mayne**  
0497 972 028

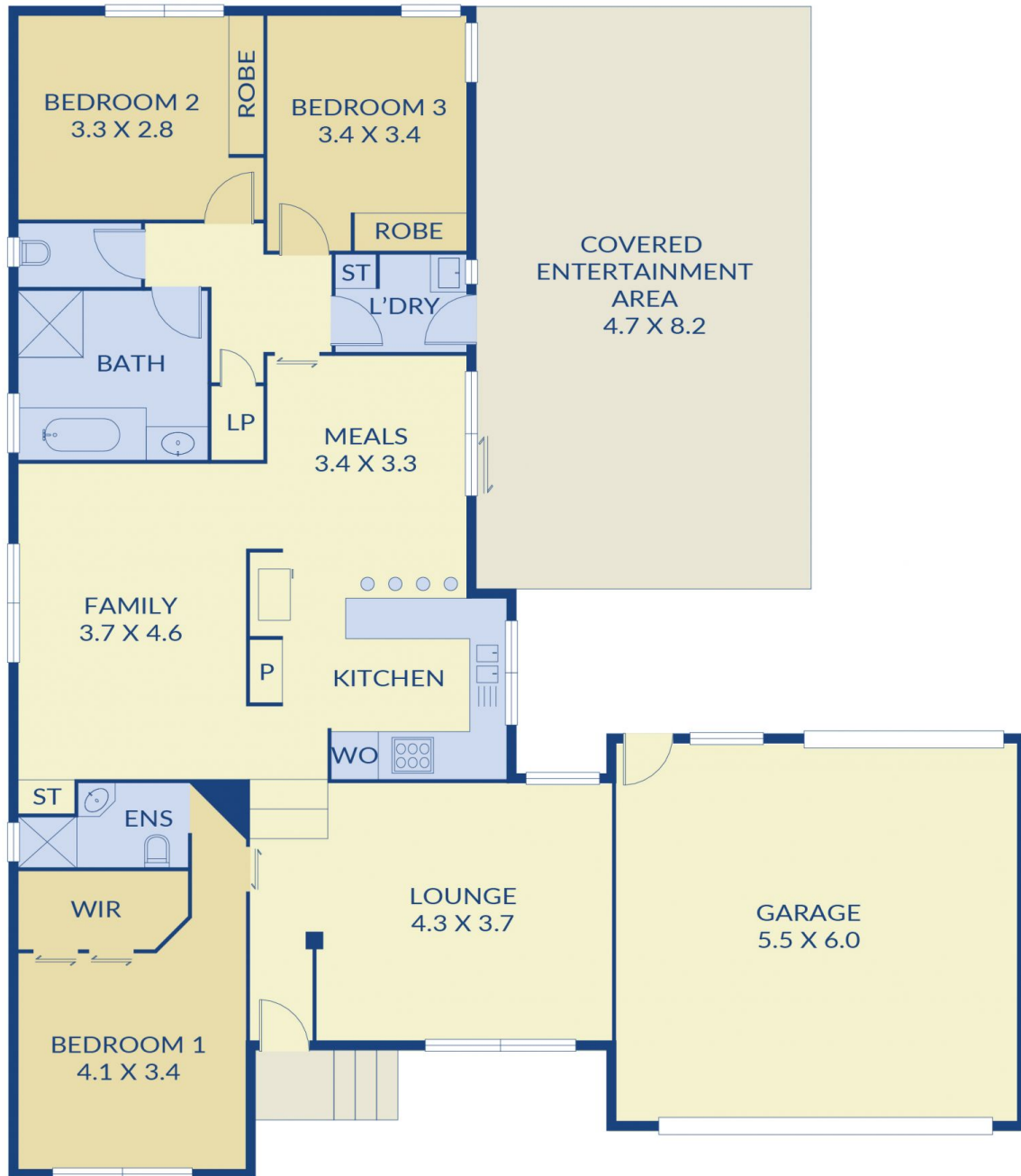

ypa

36 Kingsley drv, sunbury