



5 Lightwood Drive SUNBURY VIC

4 2 2

Situated on approximately 1340m², this special home with immaculate presentation is nestled amongst the gum trees of the highly respected & extremely prestigious Sherwood Estate and is nothing short of outstanding. As you enter you will immediately fall in love with all the features this home provides - with grand proportions, quality finishes and unforgettable entertaining spaces, the home creates an exceptional environment for family living. Only moments to Sunbury Town Centre, cafes, restaurants, highly respected schools, bike paths & public transport this outstanding home is unquestionably something you would be proud to call home.

Property features include:

4 Bedrooms with BIRs

Master with WIR & FES with spa bath

Central bathroom with double vanity powder room and separate toilet

View : <https://www.ypa.com.au/7388404>



Lisa Totaro
0410 144 215

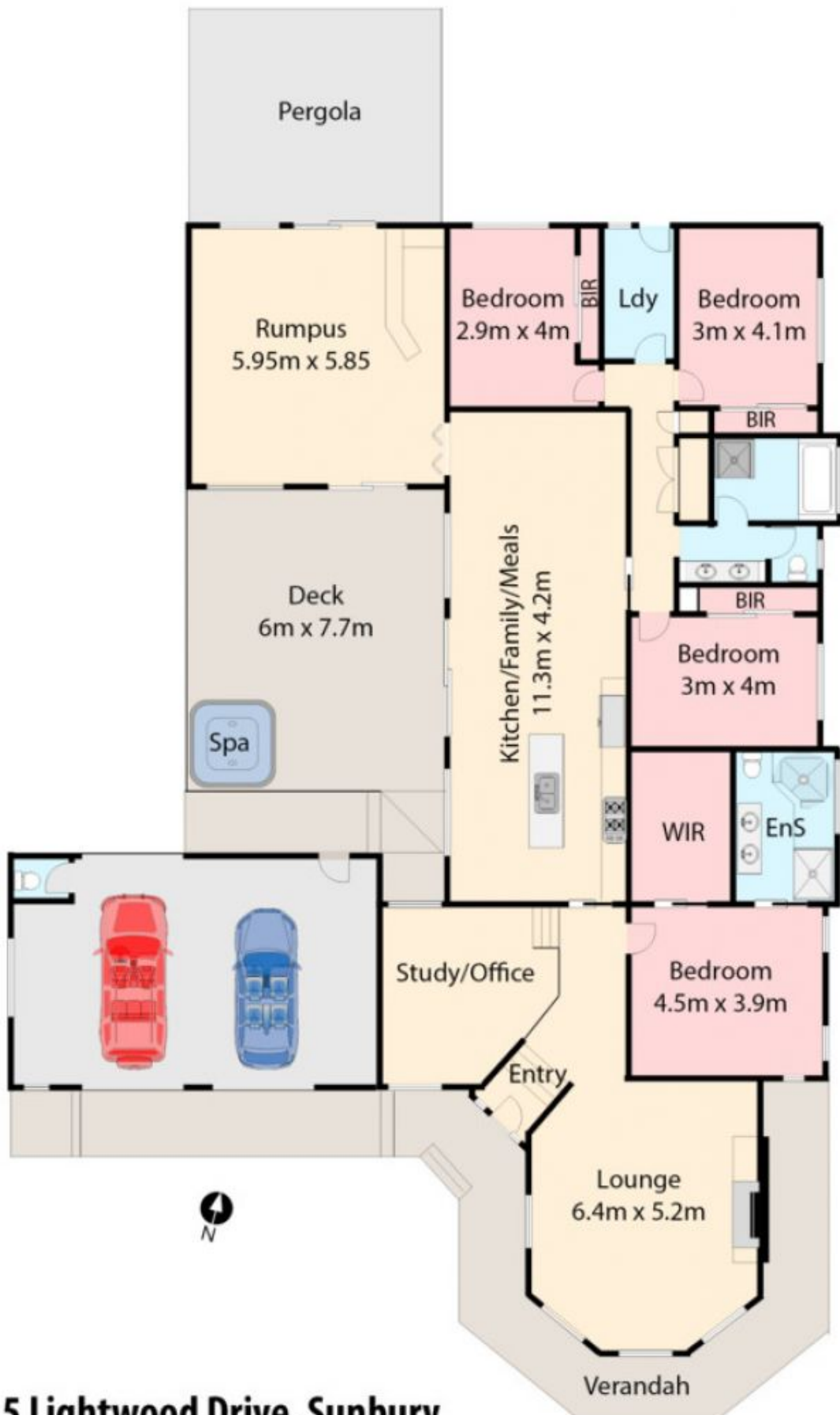

5 Lightwood Drive, Sunbury

All dimensions and data in this sketch are approximate