



22 Langbourne Way Burnside Heights VIC

5 2 2

Set in a family friendly location of Burnside Heights sits this magnificent well maintained 40 square (approx.) property on 655m² (approx.) of land which is zoned for Kororoit Creek Primary School and only moments away from public transport, gorgeous park lands, jogging track, quality secondary schools, Caroline Springs Town Centre, Watervale shopping centre and nearby train stations. Grasp this great opportunity to enter into the fast-growing market of Burnside Heights.

Features include:

- ? Master bedroom showcasing a walk in robe and ensuite with quality fittings
- ? Additional four spacious bedrooms with built in robes
- ? Theatre room
- ? The kitchen is located perfectly to incorporate the large meals and family area

Price : \$ 888,888
Land Size : 655 sqm
View : <https://www.ypa.com.au/7387191>



Andrew Migliorisi
0432 526 844



Stephen Azzopardi
0402 012 554

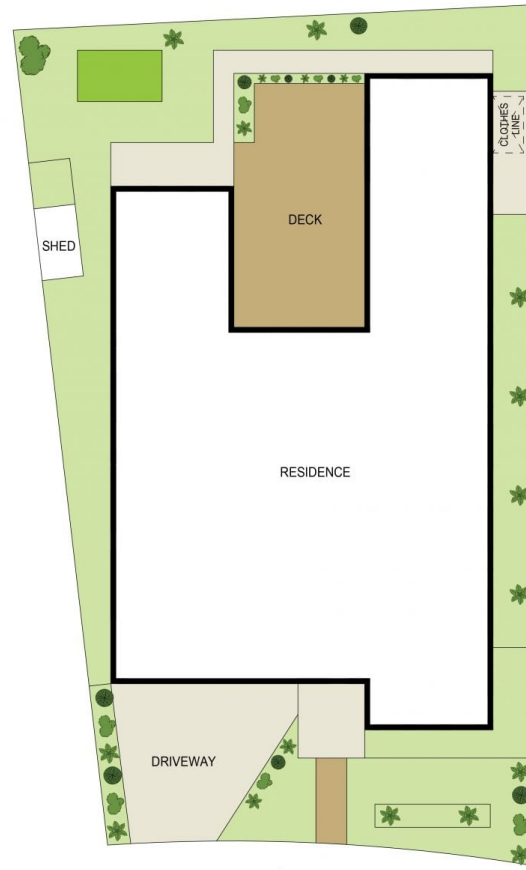

SITE PLAN
(NOT TO SCALE)

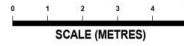

22 Langbourne Way, Burnside Heights

DISCLAIMER : ALL DIMENSIONS ARE AN APPROXIMATION ONLY AND NO GUARANTEE IS GIVEN WITH RESPECT TO ACCURACY.