



2 Isabel Close Caroline Springs VIC

3 2 2

Proudly standing in one of Caroline Springs' most popular Estate, this great family home has no wasted space, promotes simple living & will instantly impress any family, first home buyer, investor or someone looking to downsize. Positioned conveniently within close proximity to gorgeous park lands, quality primary and secondary schools, local shops, public transport, Caroline Springs Town Centre, Caroline Springs train station and easy access to Western Highway. When an opportunity like this comes along, there is no need to let it get away.

Features Include:

- ? Master bedroom showcasing a walk-in wardrobe and ensuite
- ? Additional two spacious bedrooms all with built in robes
- ? Separate front formal lounge
- ? Open plan kitchen is located perfectly to incorporate the

Price : \$ 735,000
Land Size : 448 sqm
View : <https://www.ypa.com.au/7387156>



Andrew Migliorisi
0432 526 844



Stephen Azzopardi
0402 012 554

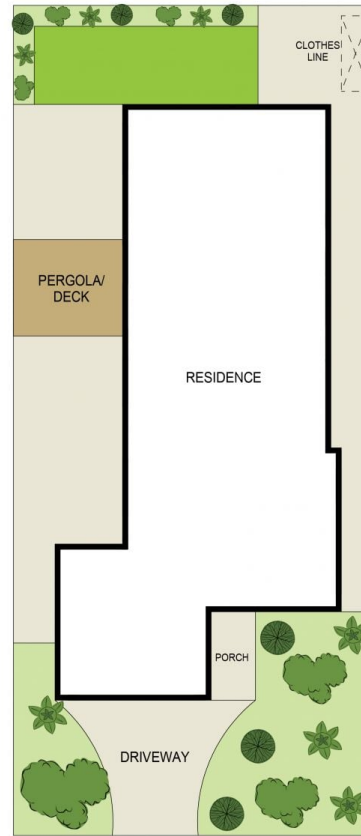

SITE PLAN
(NOT TO SCALE)

2 Isabel Close, Caroline Springs

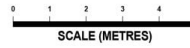

DISCLAIMER : ALL DIMENSIONS ARE AN APPROXIMATION ONLY AND NO GUARANTEE IS GIVEN WITH RESPECT TO ACCURACY.