



## 103 Chisholm Drive Caroline Springs VIC

3 2 2

When an opportunity like this comes along, there is no need to let it get away. Positioned conveniently within close proximity to gorgeous park lands, quality primary and secondary schools, local shops, public transport, Caroline Springs Town Centre, Caroline Springs train station and easy access to Western Highway. This truly stunning property is the whole package offering multiple living areas ready for the entire family to enjoy.

### Features Include:

- ? Master bedroom showcases a walk-in wardrobe and ensuite
- ? Additional two spacious bedrooms with built in wardrobes
- ? Home office or fourth bedroom
- ? Central bathroom with bathtub
- ? Separate lounge room
- ? Kitchen is located perfectly to incorporate the meals and

**Price** : \$ 620,000  
**Land Size** : 400 sqm  
**View** : <https://www.ypa.com.au/7386952>



**Andrew Migliorisi**  
0432 526 844



**Stephen Azzopardi**  
0402 012 554

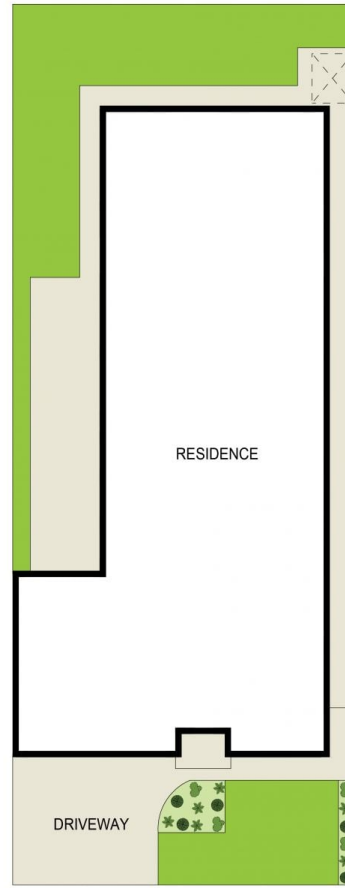

SITE PLAN  
(NOT TO SCALE)

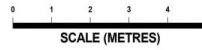

# 103 Chisholm Drive, Caroline Springs

**DISCLAIMER :** ALL DIMENSIONS ARE AN APPROXIMATION ONLY AND NO GUARANTEE IS GIVEN WITH RESPECT TO ACCURACY.