



10 Wales Court Hillside VIC

4 2 8

Proudly standing in the Regency Estate is this ideal family home on a massive allotment measuring 1919m² (approx.) for any size family with living options for those that love the indoors and outdoors. Positioned to provide a lifestyle of convenience - being within close proximity to gorgeous park lands, quality primary and secondary schools, local shops, transport facilities, nearby train station and so much more.

Features Include:

- ? Master bedroom showcasing a walk-in wardrobe and ensuite with double vanity, spa bathtub and quality fittings
- ? Additional three spacious bedrooms all with built in robes
- ? Home office
- ? Separate front formal lounge
- ? Open plan kitchen is located perfectly to incorporate the large meals and living space which leads out to an outdoor

Price : \$ 865,000
Land Size : 1919 sqm
View : <https://www.ypa.com.au/7386791>



Andrew Migliorisi
0432 526 844



Stephen Azzopardi
0402 012 554

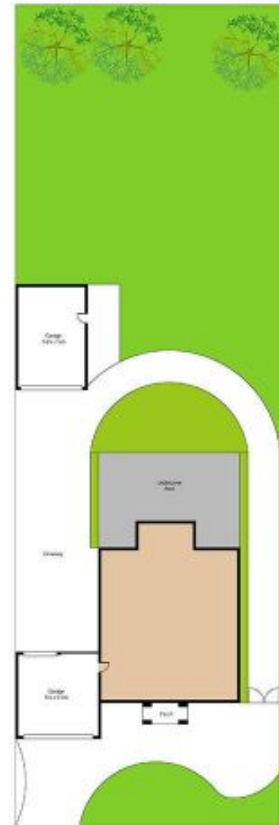
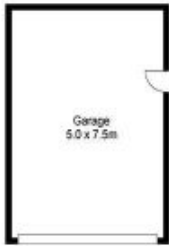

Scale in metres. Indicative only. Dimensions are approximate. All information contained herein is gathered from sources we believe to be reliable. However we cannot guarantee its accuracy and interested persons should rely on their own enquiries.

10 Wales Court, Hillside