



## 10 Wright Circuit FRASER RISE VIC

4 🏠 2 🚗 5 🚗

Immaculately kept by the original owners this quality home is set on a lovely landscaped allotment measuring approx. 571m<sup>2</sup> in a quiet & central pocket of Fraser Rise. Highlighted by a modern facade, the spacious 35 square (approx.) floorplan offers soaring square-set ceilings, an abundance of natural light throughout the home. Comprising of four spacious bedrooms all with built in robes a huge master bedroom offering walk in robe and full ensuite (double vanity), the spacious open plan kitchen includes first class stainless steel appliances, Caesar stone bench tops, glass splash back, 900mm gas cooktop, dishwasher, walk in pantry and is located perfectly to incorporate the large meals and family area allowing ample space for entertaining which leads out to a beautiful alfresco area for all year round enjoyment. Added extras include, huge pergola/entertaining area, home theatre room, central bathroom with bathtub, kids retreat, double

**View** : <https://www.ypa.com.au/7386663>

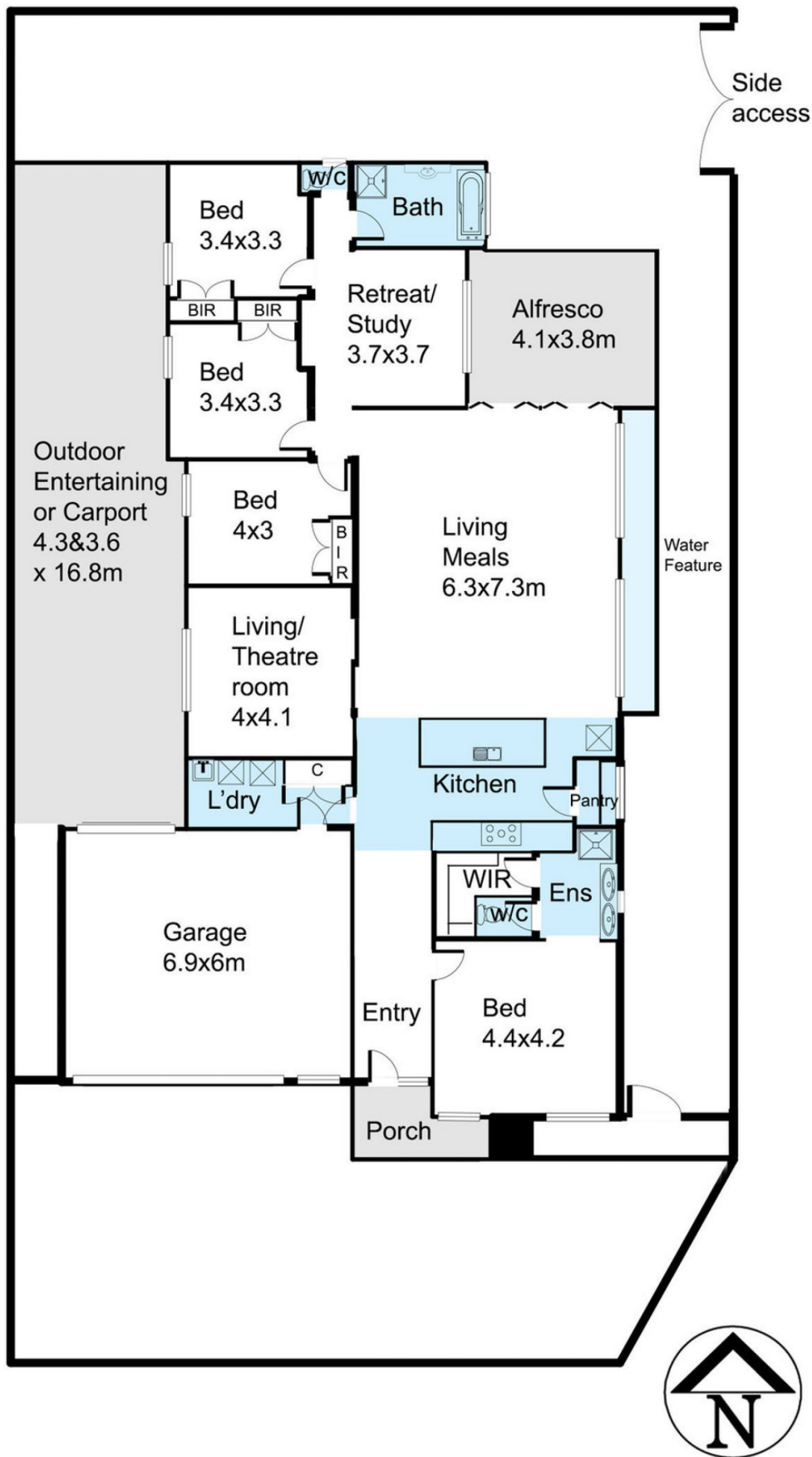

# 10 Wright Circuit, Plumpton

Scale in metres. Indicative only. Dimensions are approximate. All information contained herein is gathered from sources we believe to be reliable. However we cannot guarantee its accuracy and interested persons should rely on their own enquiries