



37 Kanmore Crescent HILLSIDE VIC

3  2  2 

Located just off Calder Park Drive and close proximity to Calder freeway, this modern home is set on a generous 560m² approx. parcel of land in the most sought after pocket of Hillside.

Comprises of the following;

Three great size bedrooms, Master with walk in robe and full ensuite, all remaining bedrooms offer built in robes.

Large formal lounge for welcoming your guests.

Open plan kitchen with stainless steel appliances overlooking dining/meals area

The adjoining rumpus room is perfect for your family entertainment.

Large colour bond gable pergola ideal for many occasions.

Massive shed for your tools and machinery safe storage.

Two dogs den as your pet's private space.

A drive through double car garage is ideal for tradies, professionals or if you are looking for that extras storage

Price : \$ 590,000

Land Size : 557 sqm

View : <https://www.ypa.com.au/7386364>

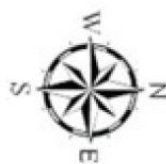
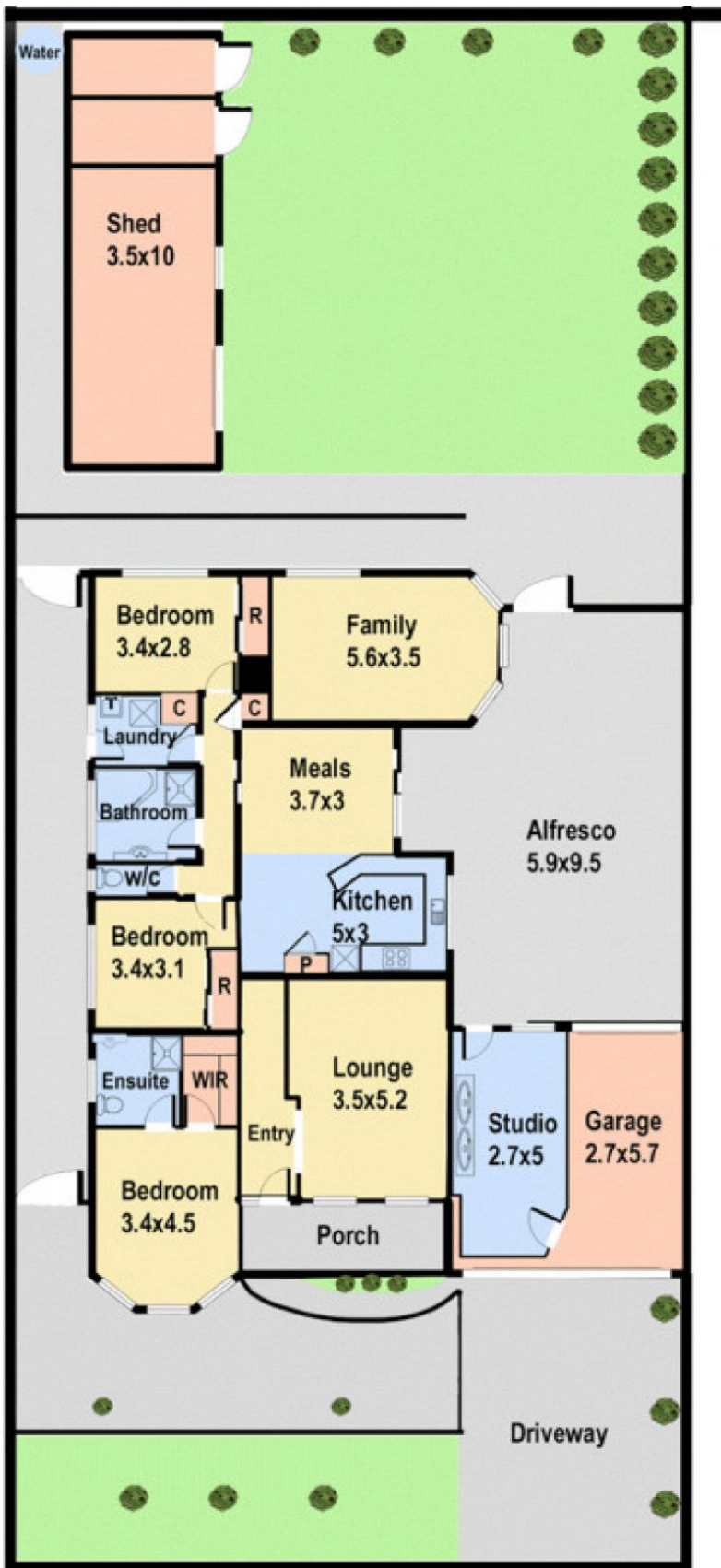

37 Kanmore Cres, Hillside

Floor plan measurements are approximate and are for illustrative purposes only. While we do not doubt the floor plan's accuracy we make no guarantee, warranty or representation as to the accuracy and completeness of the floor plan. You or your advisors should conduct a careful investigation of the property to determine your satisfaction as to the suitability for your space requirements.