

20 Windsor Gardens CAROLINE SPRINGS VIC

4  2  3 

Surround yourself with luxury, space and serenity with this immaculate family home, set on an impressive 630sqm2 (approx.) of land and 40 squares (approx.) of built up area, this Ex- Display park facing family sized home with an array of amazing features is presented to you in a manner to surely take your breath away!

Price : \$ 679,000

View : <https://www.ypa.com.au/7386267>

Boasting four generous bedrooms, the large master suite offers a private ensuite with stylish dual basin vanity, spa bath and walk in robe. All other three bedrooms offer great size with built in robes.

A massive study at the front of the home offers peaceful working from home.

Double door entrance takes you to a huge formal lounge with soaring heights and seamlessly flows to the adjoining dining area.

Another large family living/entertainment setup is strikingly



20 Windsor Gardens Caroline Springs

Floor plan measurements are approximate and are for illustrative purposes only. While we do not doubt the floor plan's accuracy we make no guarantee, warranty or representation as to the accuracy and completeness of the floor plan. You or your advisors should conduct a careful investigation of the property to determine your satisfaction as to the suitability for your space requirements.

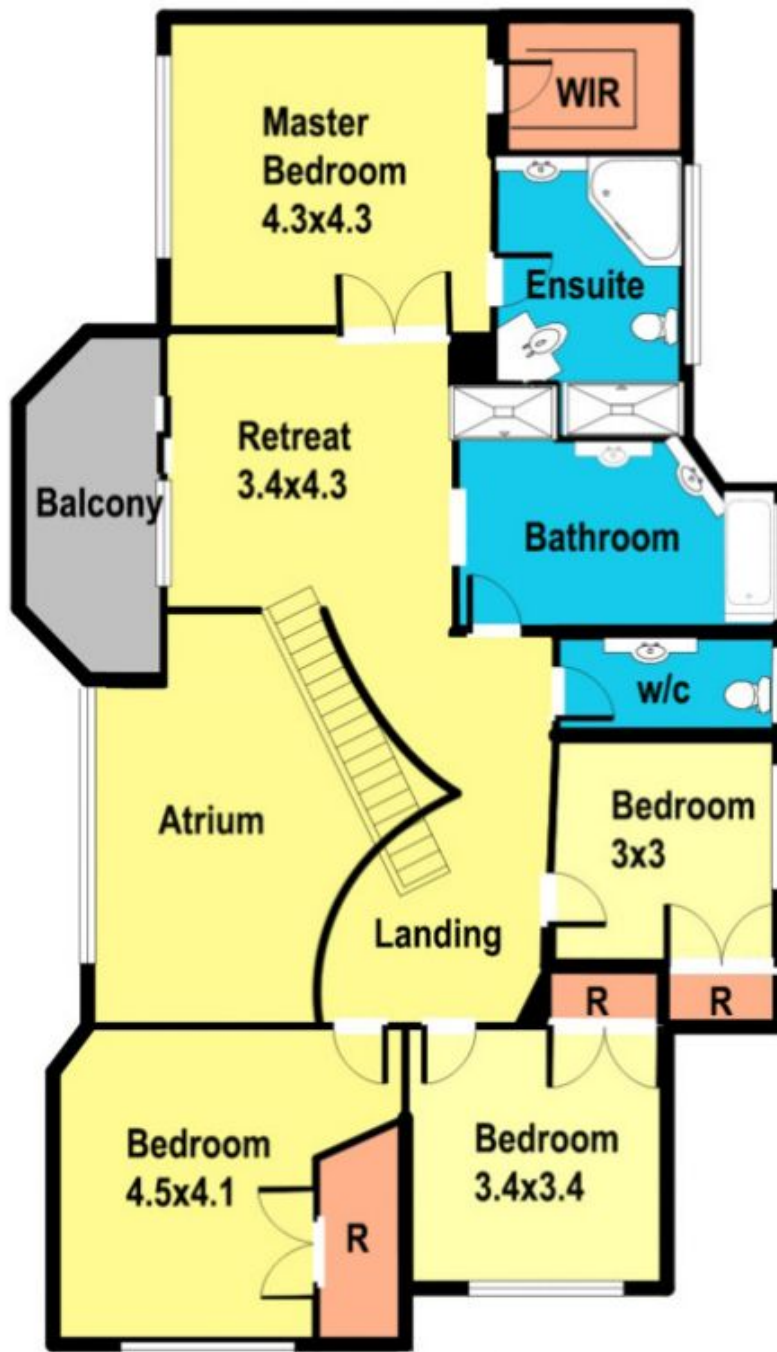

First Floor 20 Windsor Gardens Caroline Springs



Floor plan measurements are approximate and are for illustrative purposes only. While we do not doubt the floor plan's accuracy we make no guarantee, warranty or representation as to the accuracy and completeness of the floor plan. You or your advisors should conduct a careful investigation of the property to determine your satisfaction as to the suitability for your space requirements.