



1504/618 Lonsdale Street Melbourne VIC

1 1

A superb one-bedroom apartment in the heart of the CBD with every amenity at your disposal. Southern Cross station, trams, shopping outlets, cafes, bars, pubs, restaurants, Marvel Stadium, Melbourne University, RMIT University & many more Melbourne attractions all within minutes reach from this stylish Melbourne One Building.

The perfect opportunity for 1st home buyers, investors or the buyer looking for a weekend pad to simply enjoy Melbourne CBD's Vibrant Energy all year round.

A galley style kitchen with stone benches, glass splash back, gas cook-top, built-in convection microwave oven and great storage. Bedroom has a space saving sliding door, modern spacious bathroom, euro laundry, and an open living area which leads onto a private balcony. Split system heating & cooling, secure swipe/intercom entry,

View : <https://www.ypa.com.au/7383576>



Bassam Tofaili
0477 972 229

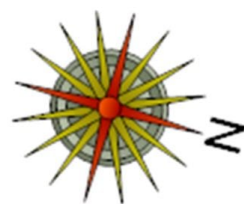
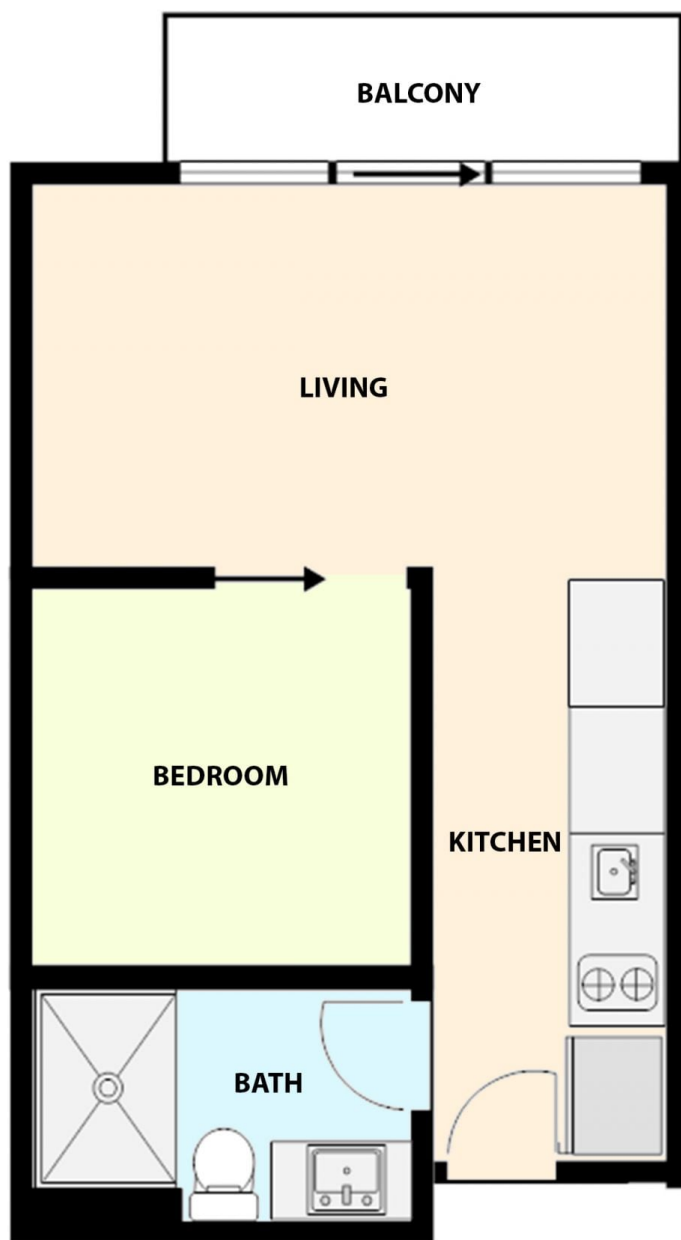

1504/618 Lonsdale Street, Melbourne