

3 Baillie Court Bacchus Marsh VIC

3 1 2

This exciting piece of real estate offers buyers who are seeking a lifestyle of relaxation and convenient location being in one of Bacchus Marsh's most desirable pockets, boasting a large 660m2 approx. block of land, all within walking distance to Main Street, Bacchus Marsh Hospital and public transport.

Price : \$ 640,000
Land Size : 660 sqm
View : <https://www.ypa.com.au/7383390>

Comprising three good sized bedrooms all with built in wardrobes, all serviced by a light filled renovated central bathroom.



Lucas Ekerbicer
0418 465 892

A spacious kitchen has ample cupboard and bench space complete with a Smeg stainless steel cooktop, oven & range hood, also featuring a dishwasher. The adjoining meals and living area are very open and spacious, completely illuminated with plenty of downlights, opening up the space even further!

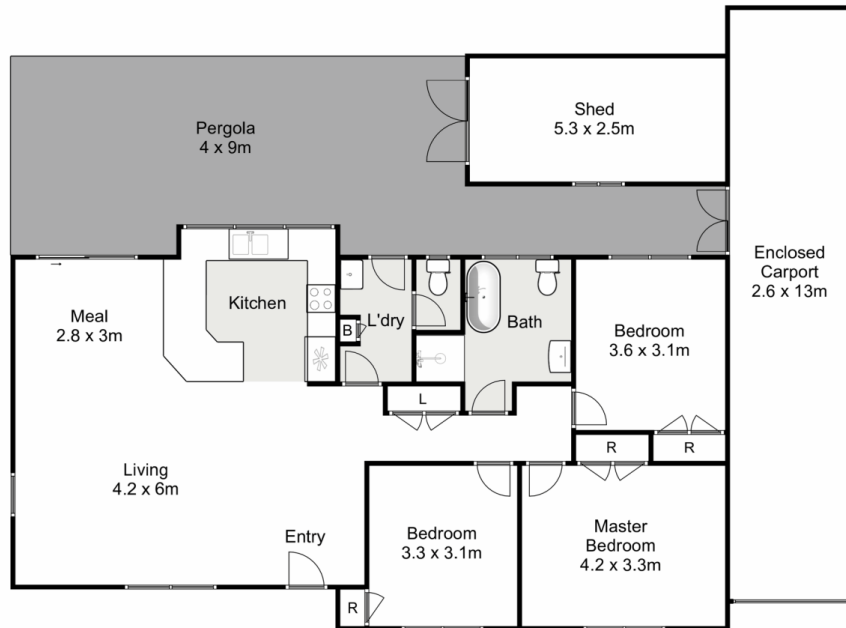

3 Baillie Court, Bacchus Marsh

ypa

Whilst every attempt has been made to ensure the accuracy of the floor plan contained here, measurements of doors, windows, rooms and any other items are approximate and no responsibility is taken for any error, omission, or mis-statement. This plan is for illustrative purposes only and should be used as such by any prospective purchaser. The services, systems and appliances shown have not been tested and no guarantee as to their operability or efficiency can be given.

