



## 4 Banadell Avenue Darley VIC

4 🏠 2 🚿 8 🚗

Designed and built for today's lifestyle, this iconic property not only offers luxurious elegance and a homey feel but boasting one of the estates best positioned blocks on roughly 4420m<sup>2</sup> (approx.) of serene native Australian environment and spectacular views.

This home featuring four bedrooms and two bathrooms, sets a new benchmark for home design featuring an extravagant and bold feel, upon entering this beautiful home, you are opened to the perfect grand atmosphere, complimented with luxury inclusions and architectural features such as corning and ceiling roses whilst still maintaining functionality.

The large master suite features a great sized walk-in wardrobe space and complete ensuite with bathtub and sliding door access to the powder room, additional three

**Price** : \$ 1,230,000  
**Land Size** : 4419 sqm  
**View** : <https://www.ypa.com.au/7383312>



**Shane O'Brien**  
0431 766 082



**Hayley Beri**  
03 5310 1333

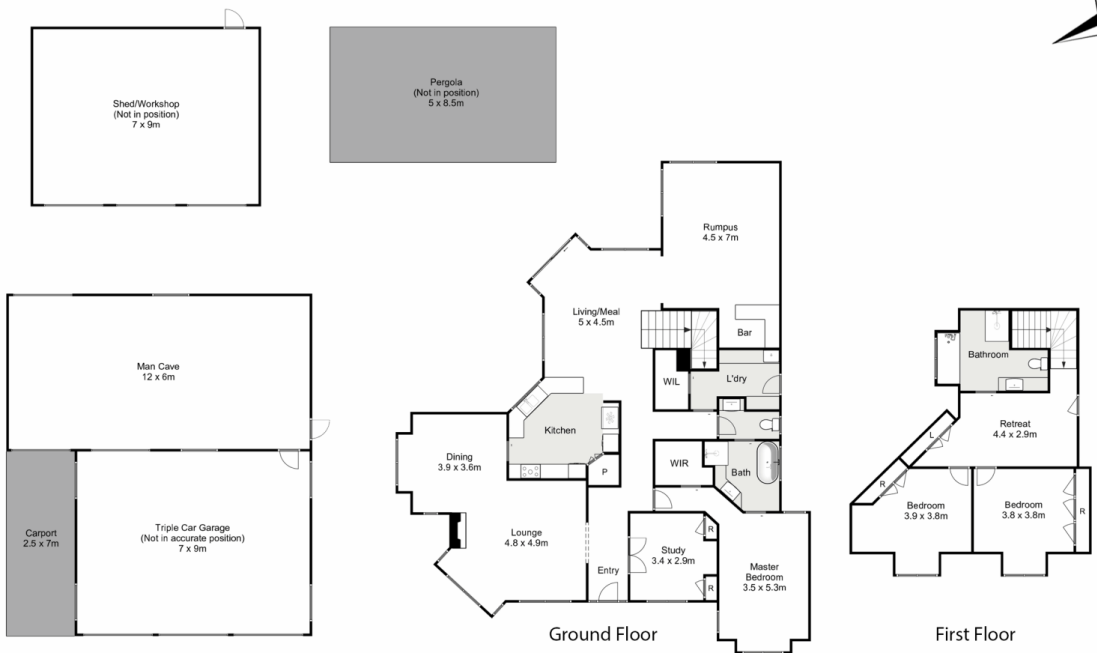

# 4 Banadell Avenue, Darley



Whilst every attempt has been made to ensure the accuracy of the floor plan contained here, measurements of doors, windows, rooms and any other items are approximate and no responsibility is taken for any error, omission, or mis-statement. This plan is for illustrative purposes only and should be used as such by any prospective purchaser. The services, systems and appliances shown have not been tested and no guarantee as to their operability or efficiency can be given.

