



35 Moore Street Maddingley VIC

3 2 1

What a perfect quiet location in Maddingley with amazing views of Bacchus Marsh.

This three bedroom home is full of character and has been lovingly updated in recent years.

Two of the bedrooms include BIRs and master having a WIR and ensuite. The lounge has beautiful cathedral ceiling with exposed timber beams. There is high quality bamboo flooring though-out the living areas with commercial grade wool carpet in the bedrooms and hall. The cabinetry in the kitchen and bathrooms is in white ironbark and red gum. Bathrooms and kitchen are fitted with quality appliances, including Kashmir granite benchtops.

The house has ceiling insulation with the addition on new

Price : \$ 620,000

Land Size : 787 sqm

View : <https://www.ypa.com.au/7383181>



Jodi Nash
0419 342 120

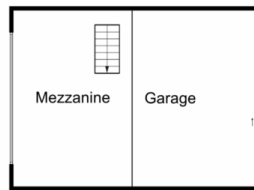

35 Moore Street, Maddingley

YPA

Whilst every attempt has been made to ensure the accuracy of the floor plan contained here, measurements of doors, windows, rooms and any other items are approximate and no responsibility is taken for any error, omission, or mis-statement. This plan is for illustrative purposes only and should be used as such by any prospective purchaser. The services, systems and appliances shown have not been tested and no guarantee as to their operability or efficiency can be given.

