

## 20 Fairbank Way MADDINGLEY VIC

4 2 2

This exciting piece of modern day architecture, positioned in the highly sought-after seclusion of the desired Stonehill Estate, completed to the definition of Turn Key with luxury inclusions and upgrades, this property is a must see due to the detail and quality throughout.

This wonderful home comprises of four bedrooms all with built in robes, feature master bedroom equipped with full Walk in Robe and ensuite finished with deluxe builders upgrades such as oversized shower and tiled shower base, floor to ceiling tiles, as well as a stone bench vanity.

The well designed open modern kitchen with walk in pantry and family/meals area seamlessly allows the natural light to flow through all living quarters, the additional formal lounge allows more than sufficient space for the potential of a designated second living, rumpus, kids or theatre room.

**Land Size** : 447 sqm  
**View** : <https://www.ypa.com.au/7383066>



**Shane O'Brien**  
0431 766 082

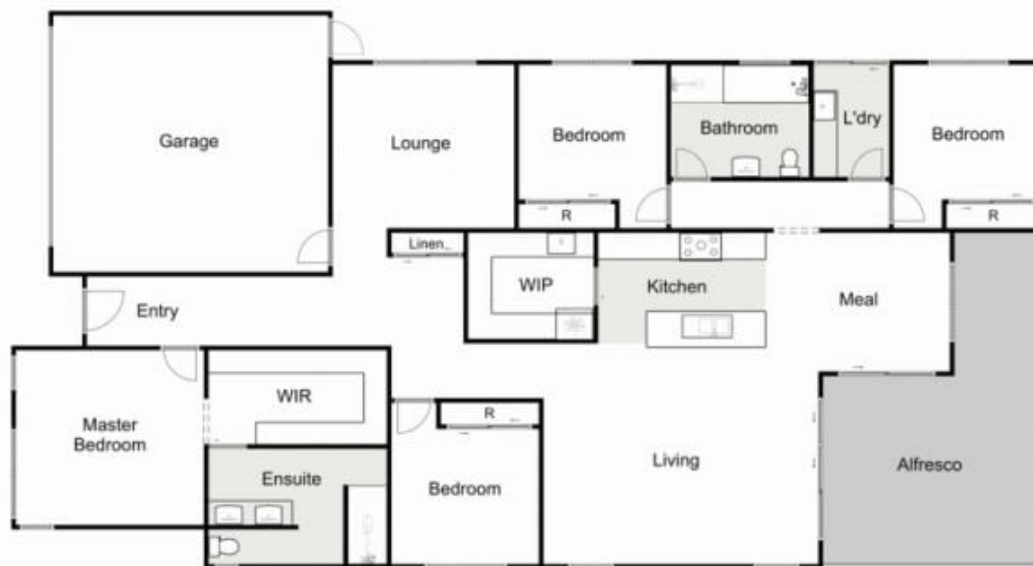

## 20 Fairbank Way, Maddingley

ypa

Whilst every attempt has been made to ensure the accuracy of the floor plan contained here, measurements of doors, windows, rooms and any other items are approximate and no responsibility is taken for any error, omission, or mis-statement. This plan is for illustrative purposes only and should be used as such by any prospective purchaser. The services, systems and appliances shown have not been tested and no guarantee as to their operability or efficiency can be given.

