

4 Labilliere Street Maddingley VIC

3  1  1 

Set on an approximately 408m² block this lovely refreshed three-bedroom home serviced by the bright spacious central bathroom comprises of an open planned and spacious living/dining area that leads into the renovated kitchen which has ample amount of bench and cupboard space.

Outside there is a covered alfresco area where you can sit back and enjoy the total privacy of the back yard which features drive through car access with a concrete floor, with potential to add a garden shed to store away all your tools. This property is zoned mixed use making this the perfect investment, close to schooling, public transport, local restaurants and only a short trip to Bacchus Marsh township, the private but prime location of this property will suit all home buyers and investors.

Price : \$ 470,000

Land Size : 408 sqm

View : <https://www.ypa.com.au/7372534>



Shane O'Brien
0431 766 082

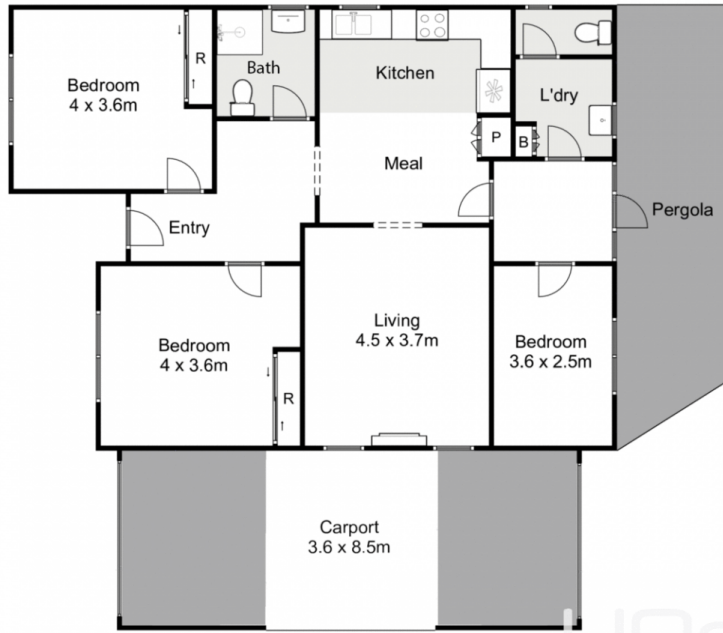

4 Labilliere Street, Maddingley

Whilst every attempt has been made to ensure the accuracy of the floor plan contained here, measurements of doors, windows, rooms and any other items are approximate and no responsibility is taken for any error, omission, or mis-statement. This plan is for illustrative purposes only and should be used as such by any prospective purchaser. The services, systems and appliances shown have not been tested and no guarantee as to their operability or efficiency can be given.

