

## 26 The Regency Hillside VIC

4 🏠 2 🚗 2 🚗

### Exceptional Family Living

Situated in the heart of Hillside conveniently located within minutes away to Royal Crescent shopping strip, Hillside Primary School, childcare, transport and 10 - minute drive to Watergardens Shopping Centre & Train Station this home is ready for your family to make memories of a lifetime.

With an impressive landscaped front garden you will be amazed with what the rest of the home has to offer. Highlighted with high ceilings throughout, this beautiful home offers four fitted bedrooms master with WIR and ensuite complete with a luxury spa, study / 5 th bonus bedroom,

**Price** : \$ 1,025,000  
**View** : <https://www.ypa.com.au/7371809>



**Peter Colella**  
0421 346 326



**Sam Bindroo**  
0404 491 997

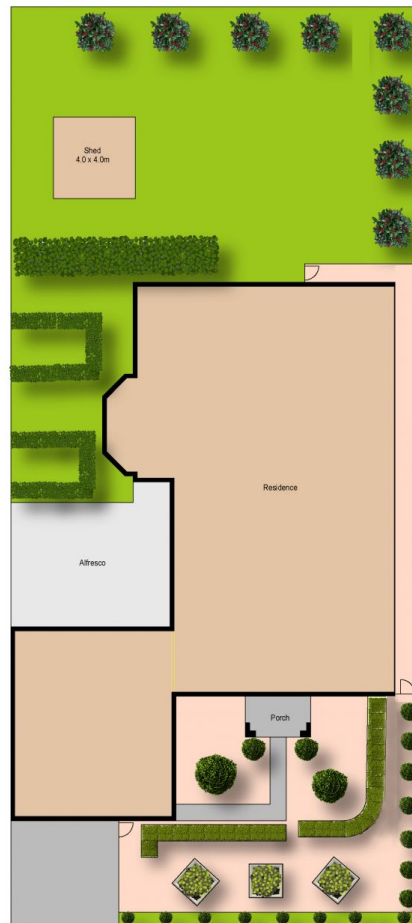
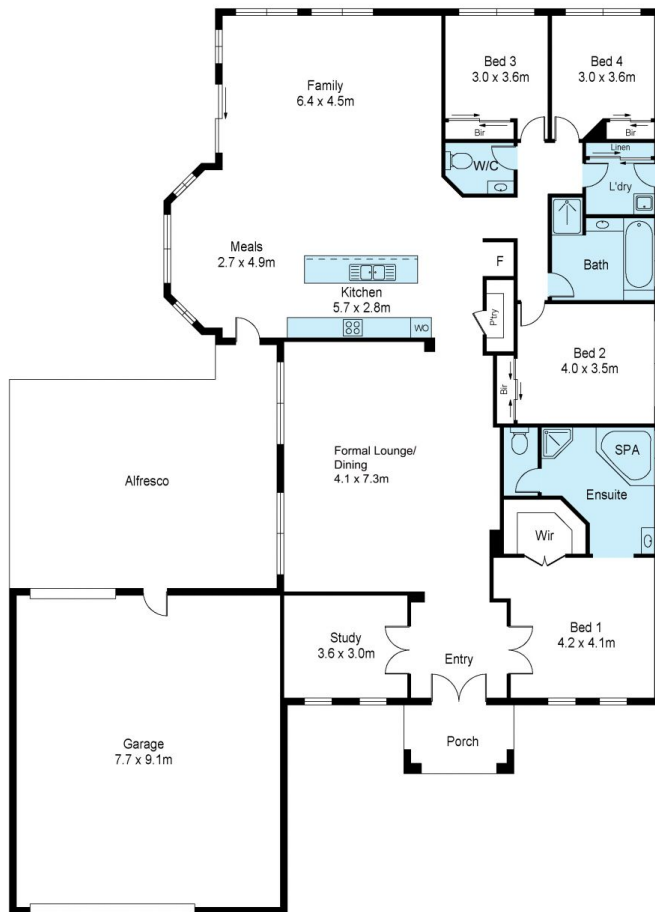

Scale in metres. Indicative only. Dimensions are approximate. All information contained herein is gathered from sources we believe to be reliable. However we cannot guarantee its accuracy and interested persons should rely on their own enquiries



## 26 The Regency Hillside