

16/45-47 Derby Street Tullamarine VIC

2 1 1

This one has it all! If you're looking for convenience and low maintenance lifestyle look no further than this spectacular villa home.

Upon entry you are greeted by a large and inviting lounge area, a bright and modern open plan living space, and to make things better, a kitchen and meals area that leads you to the decked alfresco area, perfect for unwinding or hosting. The well designed layout appeals with 2 generously sized bedrooms both with built-in robes, one of which offers access to the central (ensuite-style) bathroom, plus there's a great sized laundry and ample storage throughout.

Featuring timber flooring throughout, split-system heating/cooling, ceiling fan and gas wall heater in main living area. Includes a lock-up garage with backyard

Price : \$ 520,000
Land Size : 160 sqm
View : <https://www.ypa.com.au/7371619>



Luke Albioli
0403 700 003



Jeremy Pate
0428 085 280

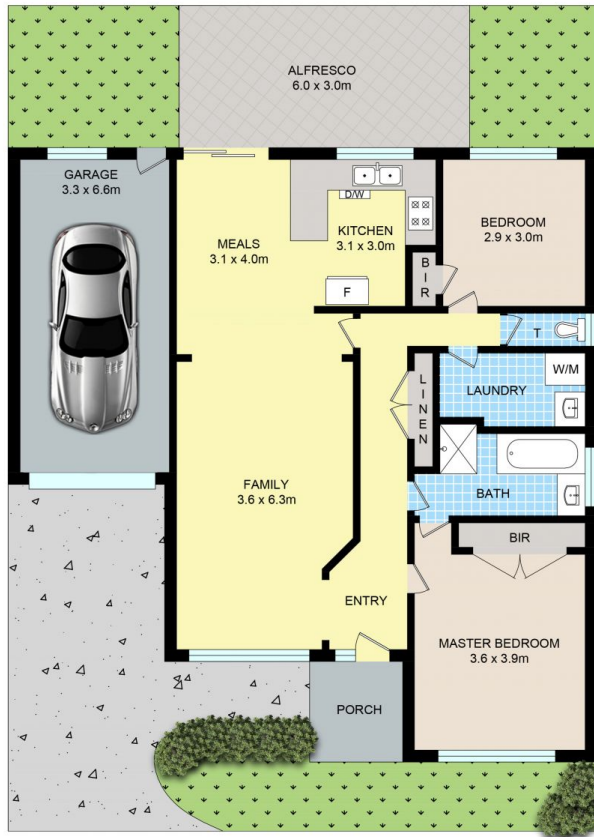

16/45-47 DERBY ST, TULLAMARINE

Disclaimer: Floor plan is for marketing purposes and is to be used as a guide only. Measurements are approximate and for illustrative purposes. Interested parties should make and rely on their own enquiries or refer to contract drawings for more accurate information.

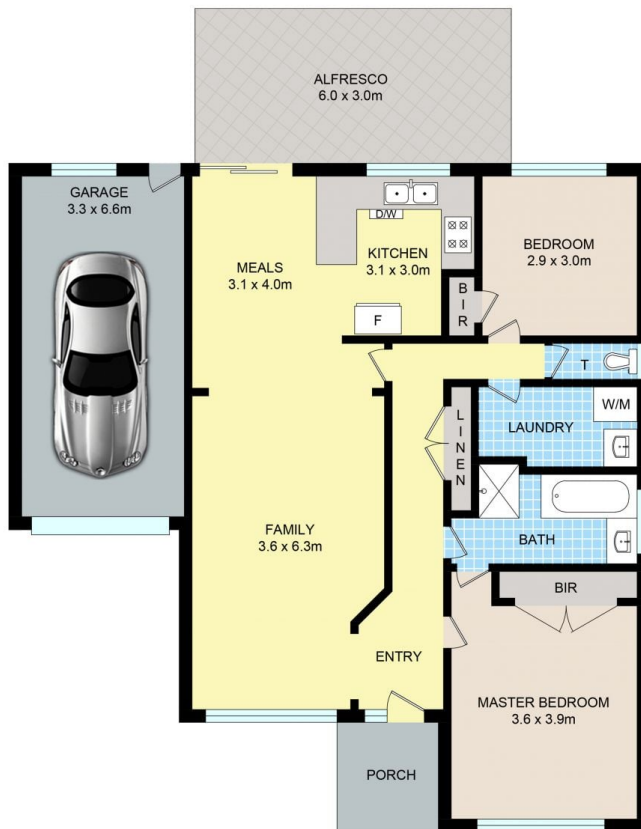

16/45-47 DERBY ST, TULLAMARINE

Disclaimer: Floor plan is for marketing purposes and is to be used as a guide only. Measurements are approximate and for illustrative purposes. Interested parties should make and rely on their own enquiries or refer to contract drawings for more accurate information.