



63 Whitneys Road Somerville VIC

4 🏠 2 🚗 6 🚗

The Ultimate Lifestyle Balance

Striking the perfect balance between work and play, presenting a wonderfully relaxed way of life, 'Sweetwater' is a 4-bedroom residence on a 7.5 Ha (approx.) working poultry farm, offering the best of both worlds with every corner of the property utilised for complete lifestyle enjoyment.

The beautifully inviting ranch-style residence flourishes with traditional country charm, enjoying timber-clad walls, wood heaters, exposed beams and soaring ceilings throughout its incredible 4-bedroom plus study layout. Introduced by a full-width entertaining deck and a gourmet kitchen with premier appliances, it features dual living zones, a home office and a magnificent live-edge wet bar for carefree entertaining in the rumpus.

Price : \$ 3,400,000
Land Size : 7.5 ha
View : <https://www.ypa.com.au/7369573>



Chris Fahl
0404 668 818



George Koklas
0414 662 738

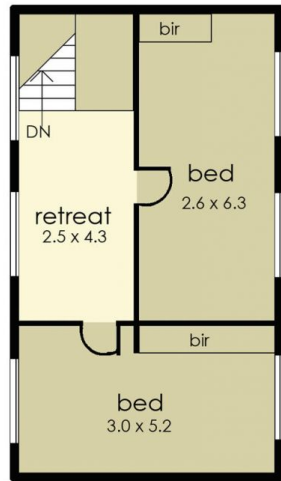

FIRST FLOOR

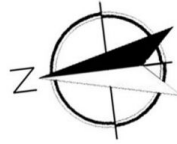

- LEGEND
- 1 Residence
 - 2 Garage 9.2 x 14m
 - 3 Triple carport
 - 4 Stables
 - 5 Shed
 - 6 Studio
 - 7 Chicken Sheds
 - 8 Dam(s)



GROUND FLOOR

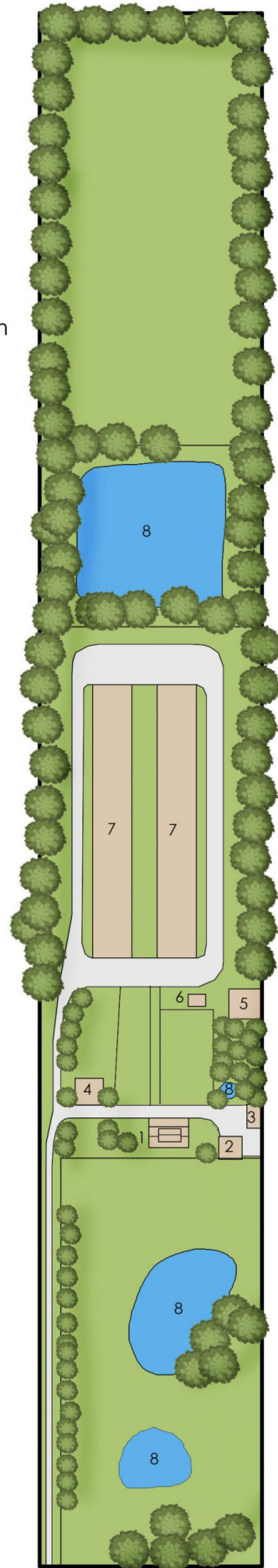

63 Whitneys Road, Somerville

This floorplan is for illustration purposes only and no warranty is given to its accuracy. Purchasers are advised to carry out their own investigations.