



34A Davisson St Epping VIC

2 2 2

Proudly presenting this architecturally designed triple story townhouse with modern flow throughout, situated in the heart of Epping. This contemporary home offers a family-friendly layout equipped and designed with the highest of standards. A location like this doesn't come often, with just a stones throw to St Peters Primary School, St Monica's College and Epping Secondary College, walking distance to Pacific Epping, Northern Hospital, Costco plus an array of dining and entertainment amenities.

The ground floor consists of internal entry from a double remote garage and a master bedroom with ensuite. Second floor comprises of open plan kitchen with quality stone benchtops, stainless steel appliances, powder room, laundry, dining and family room all this flows onto an oversized balcony. The top floor consists of an oversized

Price : \$ 555,000

View : <https://www.ypa.com.au/7365809>



Belinda Dimitrijevska
0423 924 883



Manu Kumar
0435 456 004

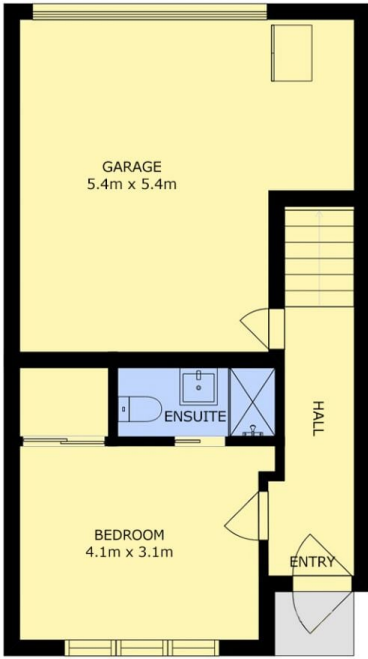

FLOOR 1

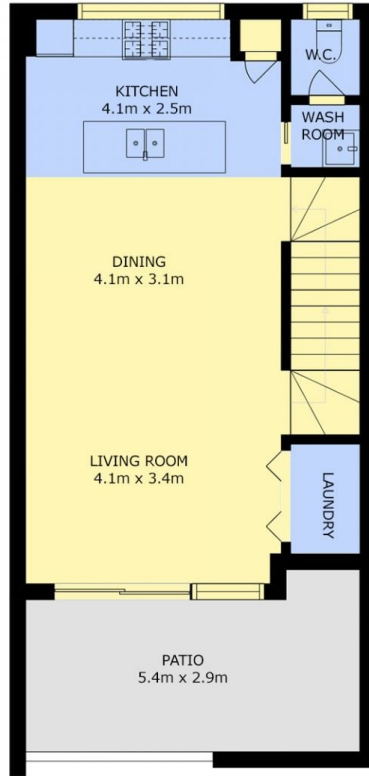

FLOOR 2



FLOOR 3

