

## 33 Cropley Crescent Laverton VIC

3 1 2

Offering the perfect location and a huge block of land this sturdy home offers the perfect opportunity to renovate or develop.

Featuring,

- Solid timber floorboards
- Kitchen Meals area with S.S up stove.
- Formal lounge,
- Central bathroom

Set on a great sized block of approx. 720m<sup>2</sup> there is scope to renovate and extend or the possibly to develop a multiple unit/ townhouse site (STCA). Positioned with easy freeway access, Laverton train station and Bladin Street shops making it the ideal location.

**Price** : \$ 602,000

**Land Size** : 720 sqm

**View** : <https://www.ypa.com.au/7362007>



**James Antonio**  
0401 889 248



FLOOR PLAN IS PROVIDED AS INDICATIVE LAYOUT ONLY, MEASUREMENTS ARE NOT AVAILABLE, FLOORPLAN IS NOT TO SCALE.  
NO GUARANTEES PROVIDED ON ACCURACY

**33 Cropley Crescent, Laverton**

# 33 Cropley Crescent, Laverton

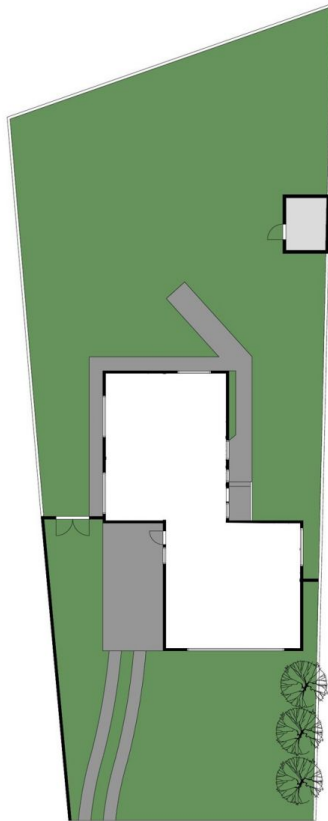

FLOOR PLAN IS PROVIDED AS INDICATIVE LAYOUT ONLY, MEASUREMENTS ARE NOT AVAILABLE, FLOORPLAN IS NOT TO SCALE.  
NO GUARANTEES PROVIDED ON ACCURACY