



## 25 John Street Werribee VIC

4 2 2

Start living the lifestyle you truly deserve with this exceptionally designed house located in an esteemed pocket on Werribee's south-side.

Fully rendered on a generous 720m2 block, this stunning home is well appointed and loaded with quality features including:

- 4 bedrooms all with robes
- Rumpus room with gas fireplace and bay view windows,
- Formal lounge and dining room with choice wall to wall carpets,
- High gloss porcelain tiles throughout the hallways and open-plan family-meals hub.
- Impressive kitchen with glass splash back, Miele stainless-steel appliances and dishwasher
- Amazing all weather outdoor entertainment area perfect for the largest of gatherings.

**Price** : \$ 780,000  
**Building Size** : 251 sqm  
**Land Size** : 720 sqm  
**View** : <https://www.ypa.com.au/7361718>



**James Christou**  
0450 733 302



**James Antonio**  
0401 889 248

# 25 JOHN STREET, WERRIBEE



SHED  
2.2 x 2.2  
(NOT IN POSITION)

SHED  
2.2 x 2.2  
(NOT IN POSITION)

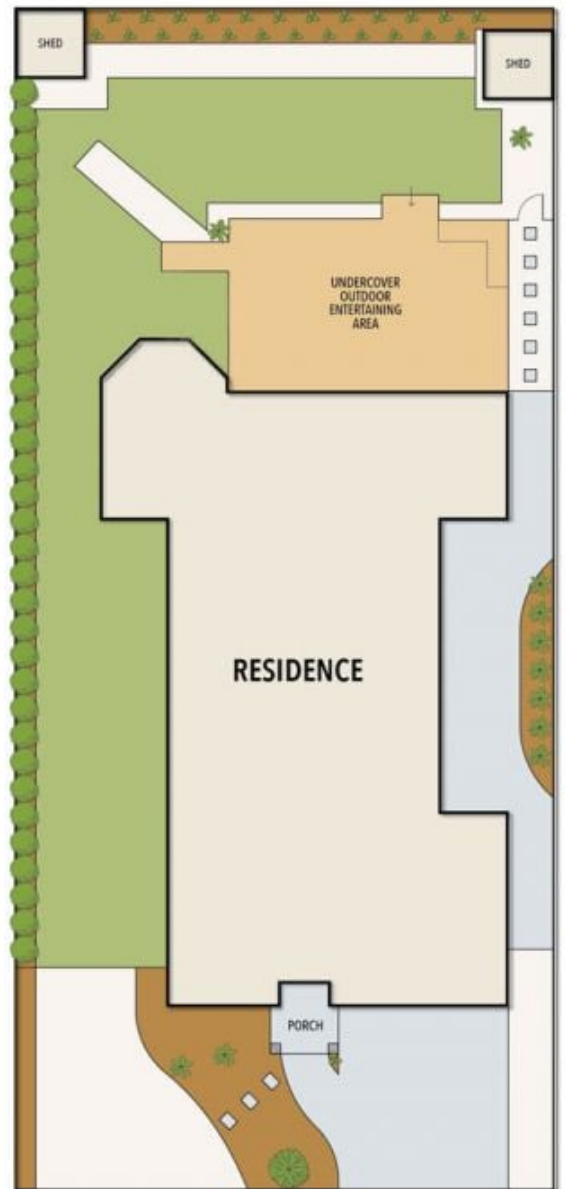

ALL STATED DIMENSIONS ARE APPROXIMATE ONLY. PARTICULARS GIVEN ARE FOR GENERAL INFORMATION ONLY AND DO NOT CONSTITUTE ANY REPRESENTATION ON THE PART OF THE VENDOR AND AGENT.